

**Attachment B-1**  
**VTRANS PAVEMENT PLANS**



**STEEL BEAM GUARDRAIL, GALVANIZED**  
 STA. 33+00 TO 34+06, RT  
 STA. 34+31 TO 34+67, RT (STOWE ST. TH-2)  
 6 PANELS @ (42' R) 8 PANELS TOTAL

**ANCHOR FOR STEEL BEAM RAIL**  
 STA. 34+06, RT  
 STA. 34+31, RT

**REMOVE AND RESET GUARDRAIL**  
 STA. 35+39 (STOWE ST.) TO  
 STA. 40+54, RT

**REPLACE GUARDRAIL BEAM UNIT**  
 STA. 35+39 (STOWE ST.) TO  
 STA. 40+54, RT (8 SECTIONS)  
 SEE SHEETS 14 & 15

**REMOVAL AND DISPOSAL OF GUARDRAIL**  
 STA. 33+00 TO 34+08, RT  
 STA. 34+31 TO 34+67, RT (STOWE ST. TH-2)

**DURABLE & TEMPORARY 4 INCH WHITE LINE**  
 (ALL LINES WILL INCLUDE EDGE LINE BREAKS  
 AND RADII FOR SIDE ROADS)  
 STA. 33+00 TO 38+00, SOLID LT & RT  
 STA. 35+39, SOLID RT (EDGELINES, STOWE ST. TH-2)  
 STA. 35+50, SOLID LT (EDGELINES, BLUSH HILL RD. TH-2)  
 STA. 33+00 TO 34+33, SOLID RT (LANE LINE)  
 STA. 36+38 TO 37+38, SOLID CL (LANE LINE)  
 STA. 37+38 TO 38+00, DOTTED CL  
 STA. 37+38 TO 38+00, DOTTED RT

**DURABLE & TEMPORARY 4 INCH YELLOW LINE**  
 (ALL LINES WILL INCLUDE CL BREAKS FOR SIDE ROADS)  
 STA. 33+00 TO 38+00, SOLID LT & RT  
 STA. 35+39, DOUBLE SOLID RT (STOWE ST. TH-2)  
 STA. 35+50, DOUBLE SOLID LT (BLUSH HILL RD. TH-2)

**DURABLE & TEMPORARY 8 INCH WHITE LINE**  
 STA. 33+00 TO 35+00, SOLID LT (DIAGONALS)

**DURABLE & TEMPORARY 24 INCH STOP BAR**  
 STA. 34+35, RT  
 STA. 35+39, RT (STOWE ST. TH-2)  
 STA. 35+50, LT (BLUSH HILL RD. TH-2)  
 STA. 36+36, LT - RT

**DURABLE LETTER OR SYMBOL, TYPE D TAPE**  
 STA. 33+51, RT "ONLY"  
 STA. 33+51, RT ARROWS (2)  
 STA. 34+22, RT ARROWS (2)  
 STA. 34+25, RT ARROW  
 STA. 34+25, RT ARROW  
 STA. 36+46, RT ARROW  
 STA. 36+49, LT ARROWS (2)  
 STA. 36+87, LT ARROWS (2)  
 STA. 36+87, RT "ONLY"  
 STA. 37+31, LT ARROWS (2)  
 STA. 37+34, RT ARROW

**TEMPORARY LETTER OR SYMBOL, PAINT**  
 STA. 33+51, RT ARROWS (2)  
 STA. 34+22, RT ARROWS (2)  
 STA. 34+25, RT ARROW  
 STA. 36+46, RT ARROW  
 STA. 36+49, LT ARROWS (2)  
 STA. 36+87, LT ARROWS (2)  
 STA. 37+31, LT ARROWS (2)  
 STA. 37+34, RT ARROW

**REMOVING SIGNS**  
 AS SHOWN - 4

**ERECTING SALVAGED SIGNS**  
 AS SHOWN - 1

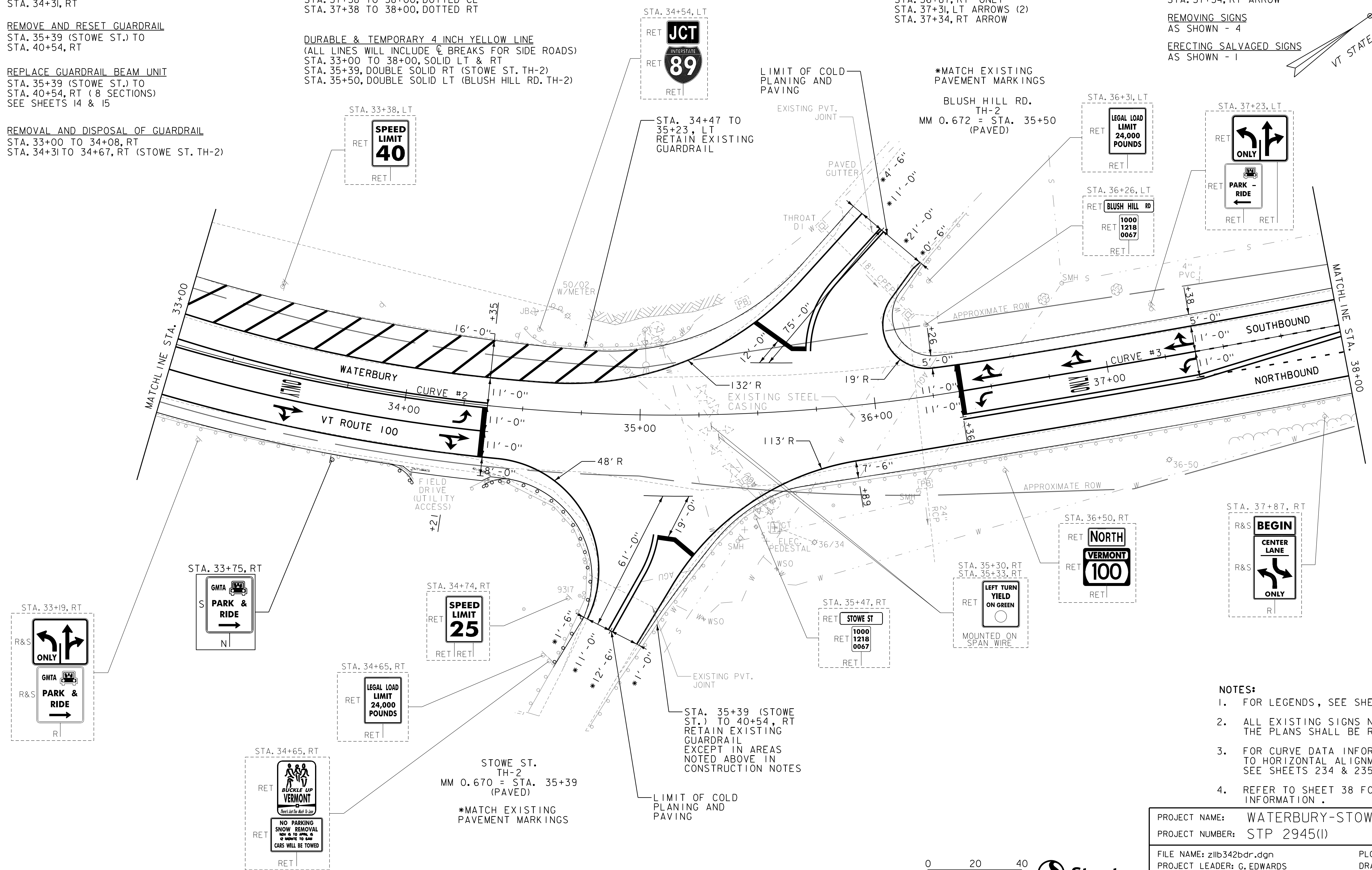
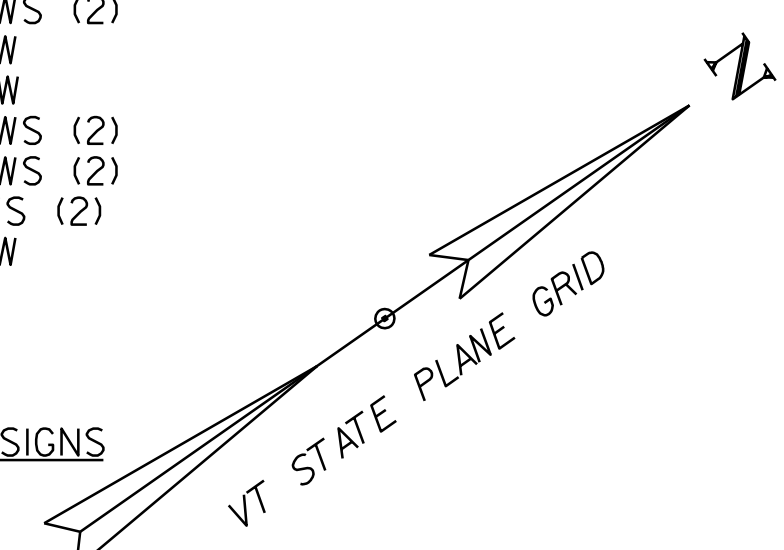

- NOTES:**
- FOR LEGENDS, SEE SHEETS 3 & 4.
  - ALL EXISTING SIGNS NOT SHOWN ON THE PLANS SHALL BE RETAINED.
  - FOR CURVE DATA INFORMATION, REFER TO HORIZONTAL ALIGNMENT TABLE SHEETS, SEE SHEETS 234 & 235.
  - REFER TO SHEET 38 FOR CULVERT INFORMATION.

PROJECT NAME: WATERBURY-STOWE  
 PROJECT NUMBER: STP 2945(I)  
 FILE NAME: z1lb342bdr.dgn  
 PROJECT LEADER: G. EDWARDS  
 DESIGNED BY: D. DRAPER  
 LAYOUT SHEET 8

PLOT DATE: 7/25/2016  
 DRAWN BY: D. DRAPER  
 CHECKED BY: M. FOISY  
 SHEET 48 OF 398

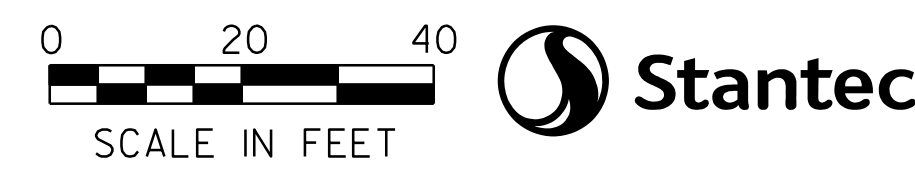

REHAB,  
Dis, CBs OR MHs, CLASS I, II OR III  
STA. 38+33, LT  
STA. 38+96, LT  
STA. 39+73, LT

CAST-IN-PLACE CONCRETE CURB, TYPE B  
STA. 41+34 TO 43+00, RT

REMOVAL OF EXISTING CURB  
STA. 41+34 TO 43+00, RT

ADJUST ELEVATION OF VALVE BOX  
(NO FEDERAL/STATE PARTICIPATION)  
STA. 41+26, RT  
STA. 41+26, RT  
STA. 41+29, RT  
STA. 41+46, RT

DURABLE & TEMPORARY 4 INCH WHITE LINE  
(ALL LINES WILL INCLUDE EDGE LINE BREAKS  
AND RADII FOR SIDE ROADS)  
STA. 38+00 TO 43+00, SOLID LT & RT  
STA. 38+00 TO 38+38, DOTTED CL  
STA. 38+00 TO 38+38, DOTTED RT  
STA. 40+30 TO 42+10, DOTTED RT  
STA. 41+40 TO 42+83, DOTTED LT  
STA. 42+10 TO 43+00, SOLID RT (LANE LINE)

DURABLE & TEMPORARY 4 INCH YELLOW LINE  
(ALL LINES WILL INCLUDE C BREAKS FOR SIDE ROADS)  
STA. 38+00 TO 38+38, DOUBLE SOLID RT  
STA. 38+38 TO 41+40, SOLID LT & RT  
STA. 38+38 TO 41+40, DASHED LT & RT  
STA. 41+40 TO 43+00, DOUBLE SOLID RT

DURABLE & TEMPORARY 8 INCH WHITE LINE  
STA. 41+34 TO 41+46, RT (HYDRANT)  
SEE SHEET 17

DURABLE & TEMPORARY 8 INCH YELLOW LINE  
STA. 41+80 TO 43+00, RT (DIAGONALS)  
SEE SHEET 17

DURABLE LETTER OR SYMBOL, TYPE D TAPE  
STA. 38+42, RT ARROW  
STA. 38+53, RT ARROW  
STA. 39+68, RT ARROW  
STA. 39+79, RT ARROW  
STA. 41+25, RT ARROW  
STA. 41+36, RT ARROW  
STA. 42+14, RT ARROW  
STA. 42+15, RT ARROW  
STA. 42+60, RT "ONLY" (2)

TEMPORARY LETTER OR SYMBOL, PAINT  
STA. 38+42, RT ARROW  
STA. 38+53, RT ARROW  
STA. 39+68, RT ARROW  
STA. 39+79, RT ARROW  
STA. 41+25, RT ARROW  
STA. 41+36, RT ARROW  
STA. 42+14, RT ARROW  
STA. 42+15, RT ARROW

REMOVING SIGNS  
AS SHOWN - 2

ERECTING SALVAGED SIGNS  
AS SHOWN - 4

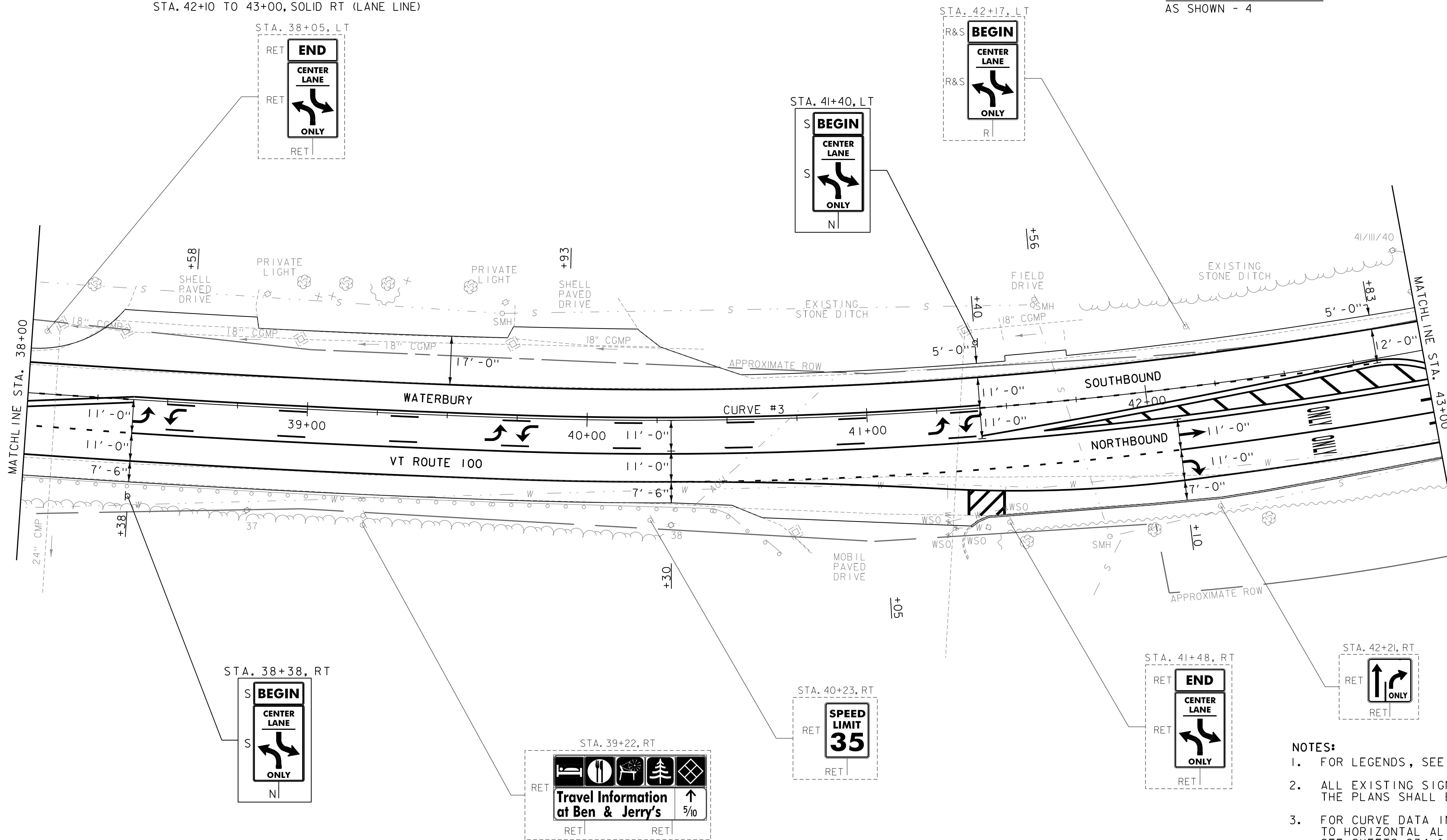
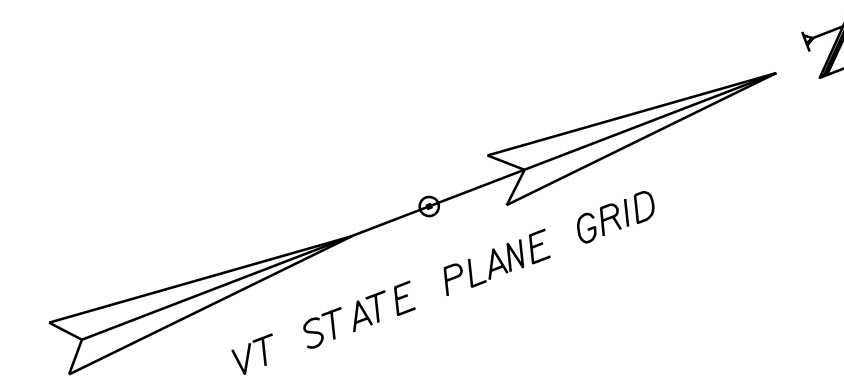

- NOTES:
- FOR LEGENDS, SEE SHEETS 3 & 4.
  - ALL EXISTING SIGNS NOT SHOWN ON THE PLANS SHALL BE RETAINED.
  - FOR CURVE DATA INFORMATION, REFER TO HORIZONTAL ALIGNMENT TABLE SHEETS, SEE SHEETS 234 & 235.
  - REFER TO SHEET 38 FOR CULVERT INFORMATION.

PROJECT NAME:	WATERBURY-STOWE
PROJECT NUMBER:	STP 2945(I)
FILE NAME:	z11b342bdr.dgn
PROJECT LEADER:	G. EDWARDS
DESIGNED BY:	D. DRAPER
LAYOUT SHEET 9	
PLOT DATE:	7/25/2016
DRAWN BY:	D. DRAPER
CHECKED BY:	M. FOISY
SHEET	49 OF 398

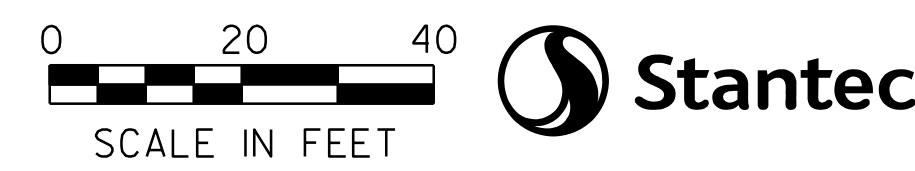

STONE FILL, TYPE J  
 STA. 47+22 TO 47+27, RT  
 SEE SHEET 18 AND NOTE 4 BELOW

PORTLAND CEMENT  
 CONCRETE SIDEWALK, 5 INCH  
 STA. 43+99, RT

DURABLE & TEMPORARY 4 INCH WHITE LINE  
 (ALL LINES WILL INCLUDE EDGE LINE BREAKS  
 AND RADII FOR SIDE ROADS)  
 STA. 43+00 TO 49+00, SOLID LT & RT  
 STA. 43+00 TO 43+10, SOLID RT (LANE LINE)  
 STA. 43+58, SOLID RT (EDGELINES & LANE LINE, SHAWS)  
 STA. 43+90 TO 46+10, SOLID RT (LANE LINE)  
 STA. 46+10 TO 48+84, DOTTED CL

DURABLE & TEMPORARY 24 INCH STOP BAR  
 STA. 43+12, RT  
 STA. 43+58, RT (SHAWS)  
 STA. 43+88, LT  
 STA. 44+28, RT

DURABLE & TEMPORARY CROSSWALK MARKING  
 STA. 43+18 TO 43+99, RT (SHAWS)  
 SEE SHEET 17 (TYP.)

GRUBBING MATERIAL  
 STA. 47+22 TO 47+27, RT  
 SEE SHEET 17

CAST-IN-PLACE CONCRETE CURB, TYPE B  
 STA. 43+00 TO 43+30, RT  
 STA. 43+92 TO 44+40, RT

DETECTABLE WARNING SURFACE  
 STA. 43+99, RT

DURABLE & TEMPORARY 4 INCH YELLOW LINE  
 (ALL LINES WILL INCLUDE C BREAKS FOR SIDE ROADS)  
 STA. 43+00 TO 43+12, DOUBLE SOLID RT  
 STA. 43+58, DOUBLE SOLID RT (SHAWS)  
 STA. 44+28 TO 48+84, DOUBLE SOLID RT  
 STA. 48+84 TO 49+00, SOLID LT & RT

DURABLE LETTER OR SYMBOL, TYPE D TAPE  
 STA. 43+00, RT ARROW  
 STA. 43+01, RT ARROW  
 STA. 43+58, RT ARROWS (2) (SHAWS)  
 STA. 43+99, LT ARROW  
 STA. 44+38, RT ARROW  
 STA. 45+00, LT "ONLY"  
 STA. 45+20, RT "ONLY"  
 STA. 46+05, LT ARROW  
 STA. 46+06, RT ARROW  
 STA. 48+37, LT "AHEAD"  
 STA. 48+78, LT "SIGNAL"

TEMPORARY LETTER OR SYMBOL, PAINT  
 STA. 43+00, RT ARROW  
 STA. 43+01, RT ARROW  
 STA. 43+58, RT ARROWS (2) (SHAWS)  
 STA. 43+99, LT ARROW  
 STA. 44+38, RT ARROW  
 STA. 46+05, LT ARROW  
 STA. 46+06, RT ARROW  
 STA. 48+37, LT "AHEAD"  
 STA. 48+78, LT "SIGNAL"

TREATED TIMBER CURB  
 STA. 47+46 TO 49+00, RT

ADJUST ELEVATION OF VALVE BOX  
 (NO FEDERAL/STATE PARTICIPATION)  
 STA. 43+93, RT

REMOVAL OF EXISTING CURB  
 STA. 43+00 TO 43+30, RT  
 STA. 43+92 TO 44+40, RT

RELOCATE MAILBOX, SINGLE SUPPORT  
 STA. 44+85, RT

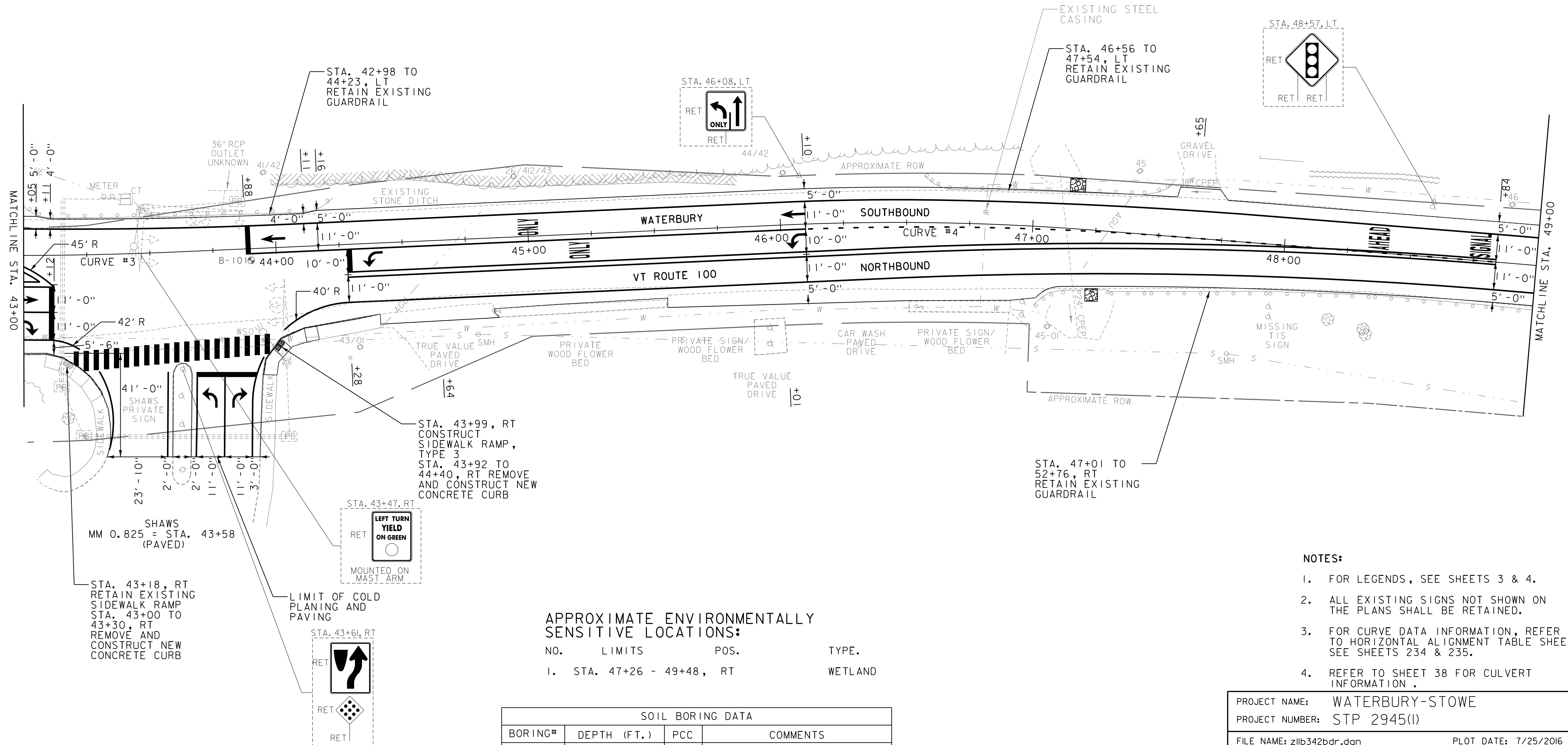
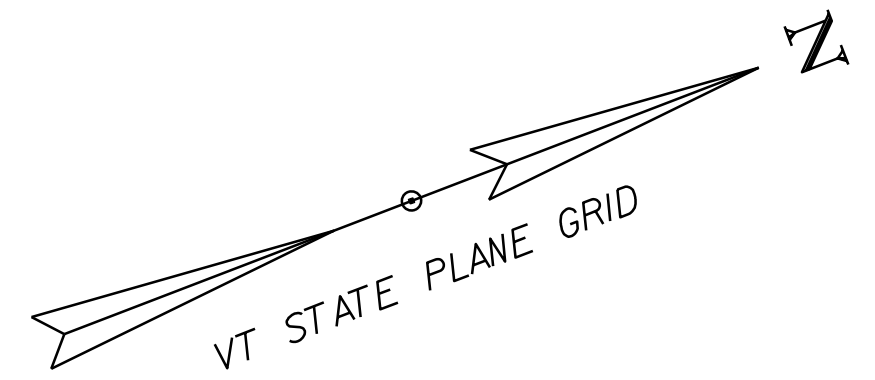

APPROXIMATE ENVIRONMENTALLY SENSITIVE LOCATIONS:

NO.	LIMITS	POS.	TYPE.
1.	STA. 47+26 - 49+48,	RT	WETLAND

SOIL BORING DATA			
BORING#	DEPTH (FT.)	PCC	COMMENTS
B-101	5.0'	NO	

- NOTES:
- FOR LEGENDS, SEE SHEETS 3 & 4.
  - ALL EXISTING SIGNS NOT SHOWN ON THE PLANS SHALL BE RETAINED.
  - FOR CURVE DATA INFORMATION, REFER TO HORIZONTAL ALIGNMENT TABLE SHEETS, SEE SHEETS 234 & 235.
  - REFER TO SHEET 38 FOR CULVERT INFORMATION.

PROJECT NAME: WATERBURY-STOWE  
 PROJECT NUMBER: STP 2945(I)  
 FILE NAME: z1lb342bdr.dgn  
 PROJECT LEADER: G. EDWARDS  
 DESIGNED BY: D. DRAPER  
 LAYOUT SHEET 10  
 PLOT DATE: 7/25/2016  
 DRAWN BY: D. DRAPER  
 CHECKED BY: M. FOISY  
 SHEET 50 OF 398

SCALE IN FEET

CHANGING ELEVATION OF Dis, CBs OR MHS  
STA. 54+95, RT DI

TREATED TIMBER CURB  
STA. 49+00 TO 52+14, RT

RELOCATE MAILBOX, SINGLE SUPPORT  
STA. 50+07, RT  
STA. 53+88, RT  
STA. 53+91, RT

DURABLE & TEMPORARY 4 INCH WHITE LINE  
(ALL LINES WILL INCLUDE EDGE LINE BREAKS  
AND RADIUS FOR SIDE ROADS)  
STA. 49+00 TO 55+00, SOLID LT & RT  
STA. 54+29, SOLID RT (EDGELINES, MILL RD. TH-20)

DURABLE & TEMPORARY 24 INCH STOP BAR  
STA. 54+29, RT (MILL RD. TH-20)

REMOVING SIGNS  
AS SHOWN - I

REHAB.  
Dis, CBs OR MHS, CLASS I, II OR III  
STA. 54+95, RT DI

ADJUST ELEVATION OF VALVE BOX  
(NO FEDERAL/STATE PARTICIPATION)  
STA. 54+30, RT

DURABLE & TEMPORARY 4 INCH YELLOW LINE  
(ALL LINES WILL INCLUDE C BREAKS FOR SIDE ROADS)  
STA. 49+00 TO 55+00, SOLID LT & RT  
STA. 54+29, DOUBLE SOLID RT (MILL RD. TH-20)

DURABLE & TEMPORARY LETTER OR SYMBOL  
STA. 54+29, RT "STOP" (MILL RD. TH-20)

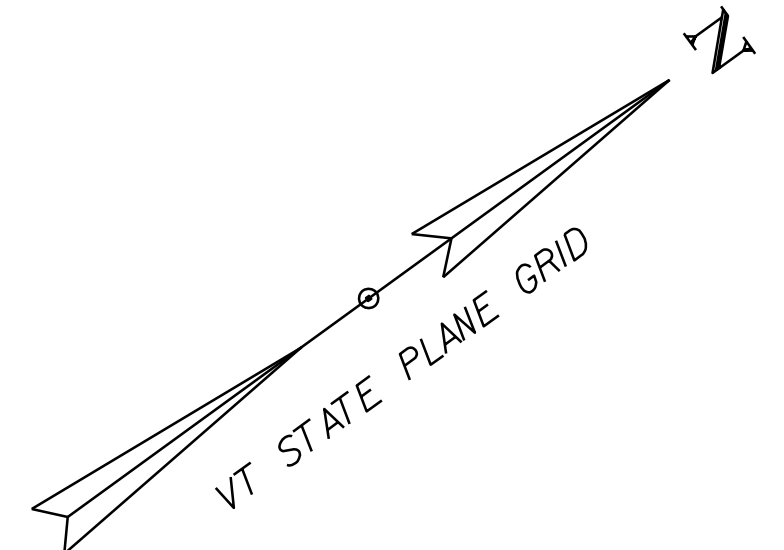

RET	Lee Zachary's right on US 2	↑	8/10
RET	Stowe Street Shops & Restaurants 2nd left	←	9/10
RET	Blush Hill CC next right	→	2
RET			

STA. 50+68.80  
END TRANSITION  
BEGIN CONCRETE REMOVAL  
(SEE SHEET 8)

STA. 49+68.80  
BEGIN TRANSITION  
STOP COLD PLANE  
(ITEM 210.10)  
BEGIN COLD PLANING  
SPECIAL PROVISION  
(ITEM 900.675)

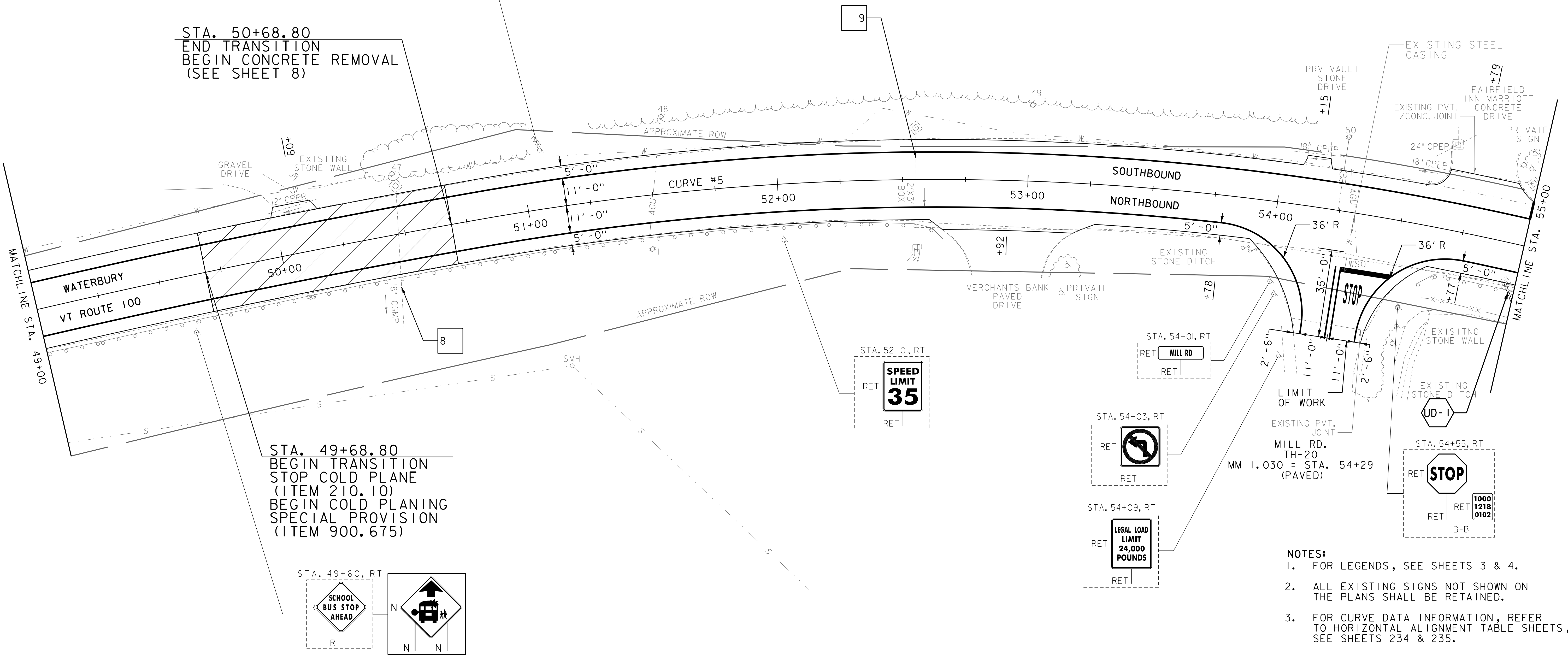

- NOTES:**
- FOR LEGENDS, SEE SHEETS 3 & 4.
  - ALL EXISTING SIGNS NOT SHOWN ON THE PLANS SHALL BE RETAINED.
  - FOR CURVE DATA INFORMATION, REFER TO HORIZONTAL ALIGNMENT TABLE SHEETS, SEE SHEETS 234 & 235.
  - REFER TO SHEET 38 FOR CULVERT INFORMATION.

 TRANSITION AREA  
(FOR DETAIL SEE SHEET 10)

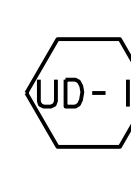
 STA. 55+00 TO 56+25, RT  
CONSTRUCT 6 INCH UNDERDRAIN PIPE,  
SEE SHEET 35 FOR DETAILS AND  
ASSOCIATED QUANTITIES



PROJECT NAME:	WATERBURY-STOWE
PROJECT NUMBER:	STP 2945(I)
FILE NAME:	z1lb342bdr.dgn
PROJECT LEADER:	G. EDWARDS
DESIGNED BY:	D. DRAPER
LAYOUT SHEET II	
PLOT DATE:	7/25/2016
DRAWN BY:	D. DRAPER
CHECKED BY:	M. FOISY
SHEET	51 OF 398

**CLEARING AND GRUBBING, INCLUDING INDIVIDUAL TREES AND STUMPS**  
 STA. 58+99, LT  
 THINNING AND TRIMMING FOR SIGN (FOR DETAIL, SEE SHEET 242)

**ADJUST ELEVATION OF VALVE BOX (NO FEDERAL/STATE PARTICIPATION)**  
 STA. 58+78, LT  
 STA. 58+79, LT

**DURABLE & TEMPORARY 4 INCH YELLOW LINE**  
 (ALL LINES WILL INCLUDE C BREAKS FOR SIDE ROADS)  
 STA. 55+00 TO 60+00, SOLID LT & RT  
 STA. 59+04, DOUBLE SOLID LT (CROSS RD. TH-15)  
 STA. 59+66, DOUBLE SOLID RT (LAUREL RD. TH-21)

**DURABLE & TEMPORARY 24 INCH STOP BAR**  
 STA. 59+04, LT (CROSS RD. TH-15)  
 STA. 59+66, RT (LAUREL RD. TH-21)

**DURABLE & TEMPORARY LETTER OR SYMBOL**  
 STA. 59+04, LT "STOP" (CROSS RD. TH-15)  
 STA. 59+66, RT "STOP" (LAUREL RD. TH-21)

**CHANGING ELEVATION OF Dis, CBs OR MHS**  
 STA. 57+40, RT MH (UNKNOWN)  
 STA. 57+40, RT DI  
 STA. 57+62, LT DI  
 STA. 59+21, LT DI  
 STA. 59+61, LT DI

**DURABLE & TEMPORARY 4 INCH WHITE LINE**  
 (ALL LINES WILL INCLUDE EDGE LINE BREAKS AND RADII FOR SIDE ROADS)  
 STA. 55+00 TO 60+00, SOLID LT & RT  
 STA. 59+04, SOLID LT (EDGELINES, CROSS RD. TH-15)  
 STA. 59+66, SOLID RT (EDGELINES, LAUREL RD. TH-21)

**DURABLE & TEMPORARY 8 INCH WHITE LINE**  
 STA. 55+00 TO 55+12, SOLID LT (HYDRANT)  
 STA. 59+31 TO 59+43, SOLID LT (HYDRANT)  
 SEE SHEET 17

**REHAB, Dis, CBs OR MHS, CLASS I, II OR III**  
 STA. 57+40, RT MH (UNKNOWN)  
 STA. 57+40, RT  
 STA. 57+62, LT  
 STA. 59+21, LT  
 STA. 59+61, LT

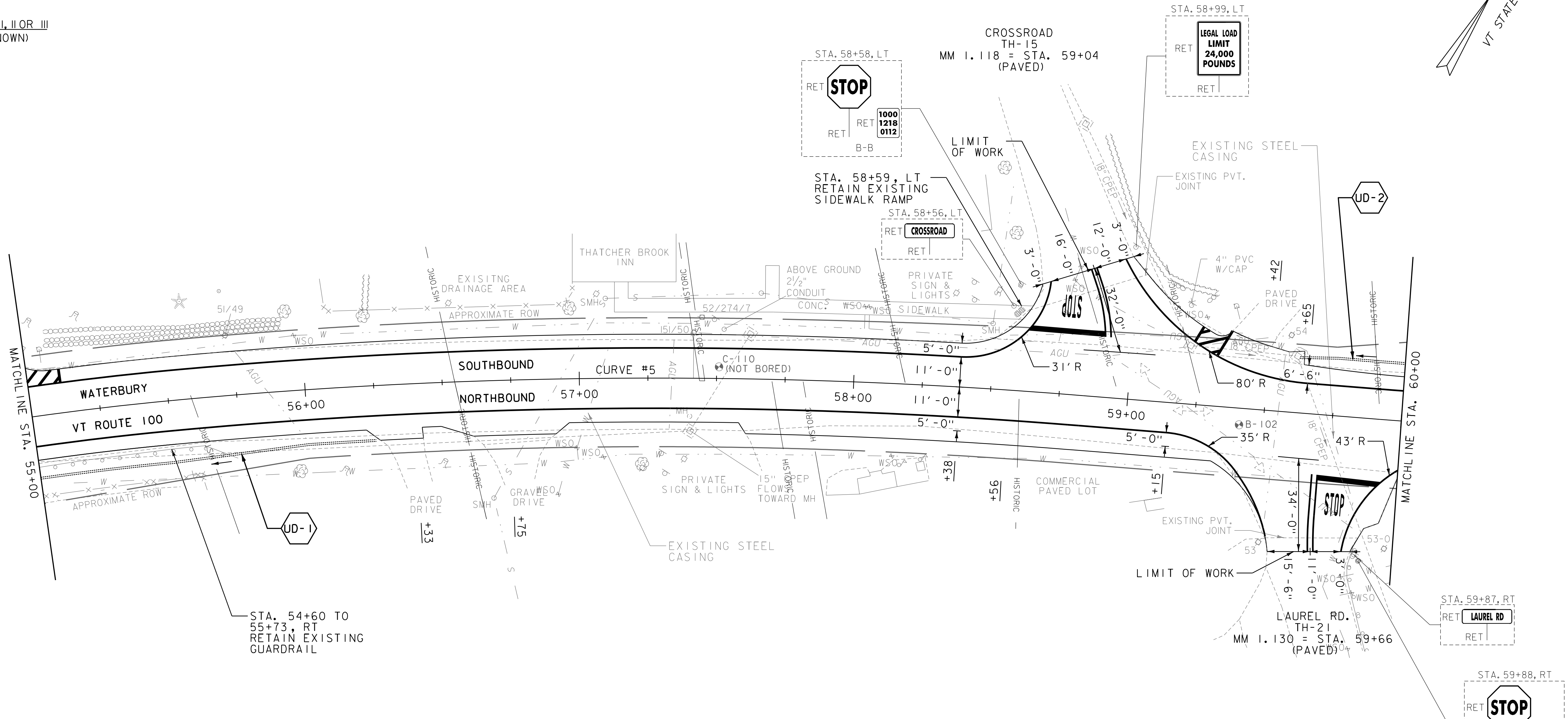
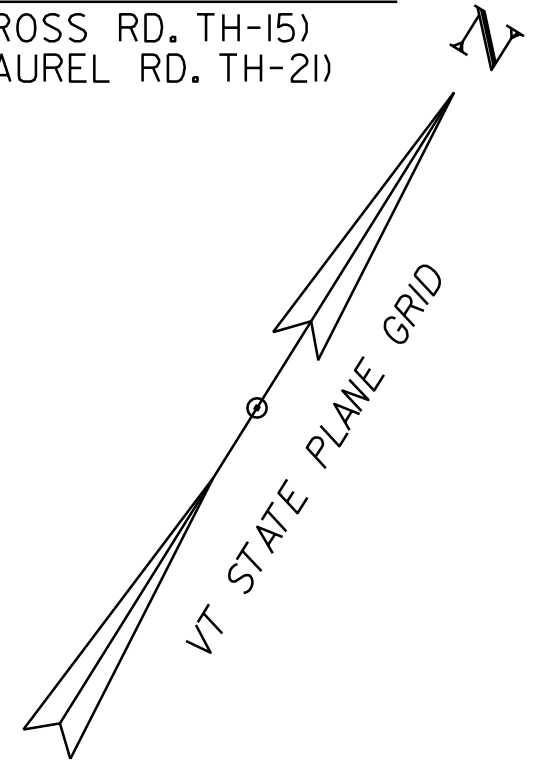

- NOTES:**
- FOR LEGENDS, SEE SHEETS 3 & 4.
  - ALL EXISTING SIGNS NOT SHOWN ON THE PLANS SHALL BE RETAINED.
  - FOR CURVE DATA INFORMATION, REFER TO HORIZONTAL ALIGNMENT TABLE SHEETS, SEE SHEETS 234 & 235.
  - REFER TO SHEET 38 FOR CULVERT INFORMATION.

- UD-1:** STA. 55+00 TO 56+25, RT CONSTRUCT 6 INCH UNDERDRAIN PIPE, SEE SHEET 35 FOR DETAILS AND ASSOCIATED QUANTITIES
- UD-2:** STA. 59+65 TO 63+45, LT CONSTRUCT 6 INCH UNDERDRAIN PIPE, SEE SHEET 35 FOR DETAILS AND ASSOCIATED QUANTITIES

SOIL BORING DATA			
BORING#	DEPTH (FT.)	PCC	COMMENTS
B-102	5.0'	YES	

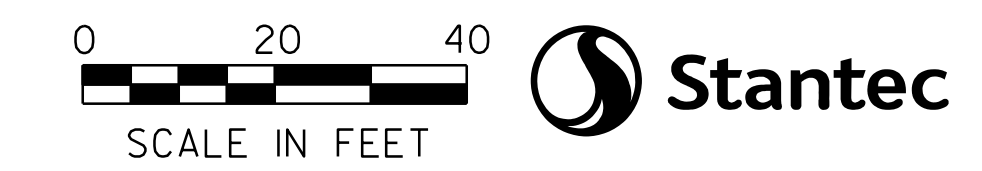

PROJECT NAME: WATERBURY-STOWE  
 PROJECT NUMBER: STP 2945(I)  
 FILE NAME: z1lb342bdr.dgn  
 PROJECT LEADER: G. EDWARDS  
 DESIGNED BY: D. DRAPER  
 LAYOUT SHEET 12  
 PLOT DATE: 7/25/2016  
 DRAWN BY: D. DRAPER  
 CHECKED BY: M. FOISY  
 SHEET 52 OF 398

